

108. CLEAN STEAM SEPARATOR

Function:

- Steam separator is used to remove the condensate from the steam. This in turn increases the efficiency of the system.

Specifications:

- Sizes: Refer table
- Connections: Triclamp(Refer table)
- Material: Contact parts: AISI 316L
Non contact parts: AISI 304
- Seals: PTFE
- Surface finish:
Internal: Electropolished $Ra < 0.5\mu$.
External finish: Polished.

Application:

- In sterilization applications condensate will reduce the efficiency of the heat transfer between the steam and the surface being sterilized. Use of clean steam separator increases the efficiency of the system.
Condensate and hence moisture also affects control valve and other pipeline equipment

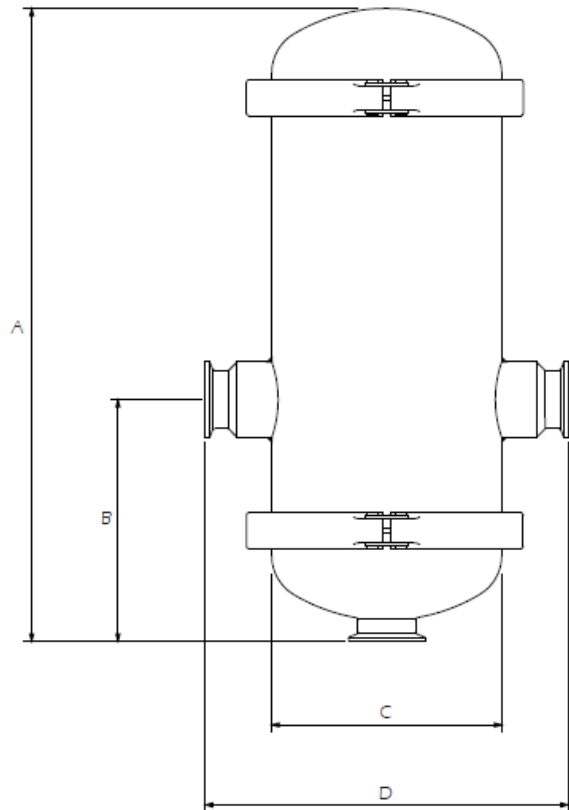

Part#	Size	A (mm)	B (mm)	C (mm)	D (mm)	End connection	Tube OD(mm)
108.000.000	1/2"	300	130	101	147	25 flange	12.7
108.000.001	3/4"	300	130	101	147	25 flange	19.05
108.000.002	1"	300	130	101	147	50.4 flange	25.4
108.000.003	1.5"	425	160	152	240	50.4 flange	38.1
108.000.004	2.0"	530	200	168	240	64 flange	50.8
108.000.005	2.5"	570	220	168	240	76.2 flange	63.5
108.000.006	3.0"	655	250	168	240	91 flange	76.2

*typically, a line sized unit will be suitable based on a maximum steam velocity of 25 m/s.

All dimensions are in mm. unless and otherwise specified.

The information contained in this brochure is for guidance only. We reserve the right to modify any material or feature without notice in advance. For further information, please, consult our application specialist.

GEOMETRY ENGINEERING INNOVATION,

No 4, Basaveshwara Industrial Area, Rajagopalnagar Main road, Bangalore-560056

www.geiprocess.com. E-mail:info@geiprocess.com

